

DS, DP, DA SERIES

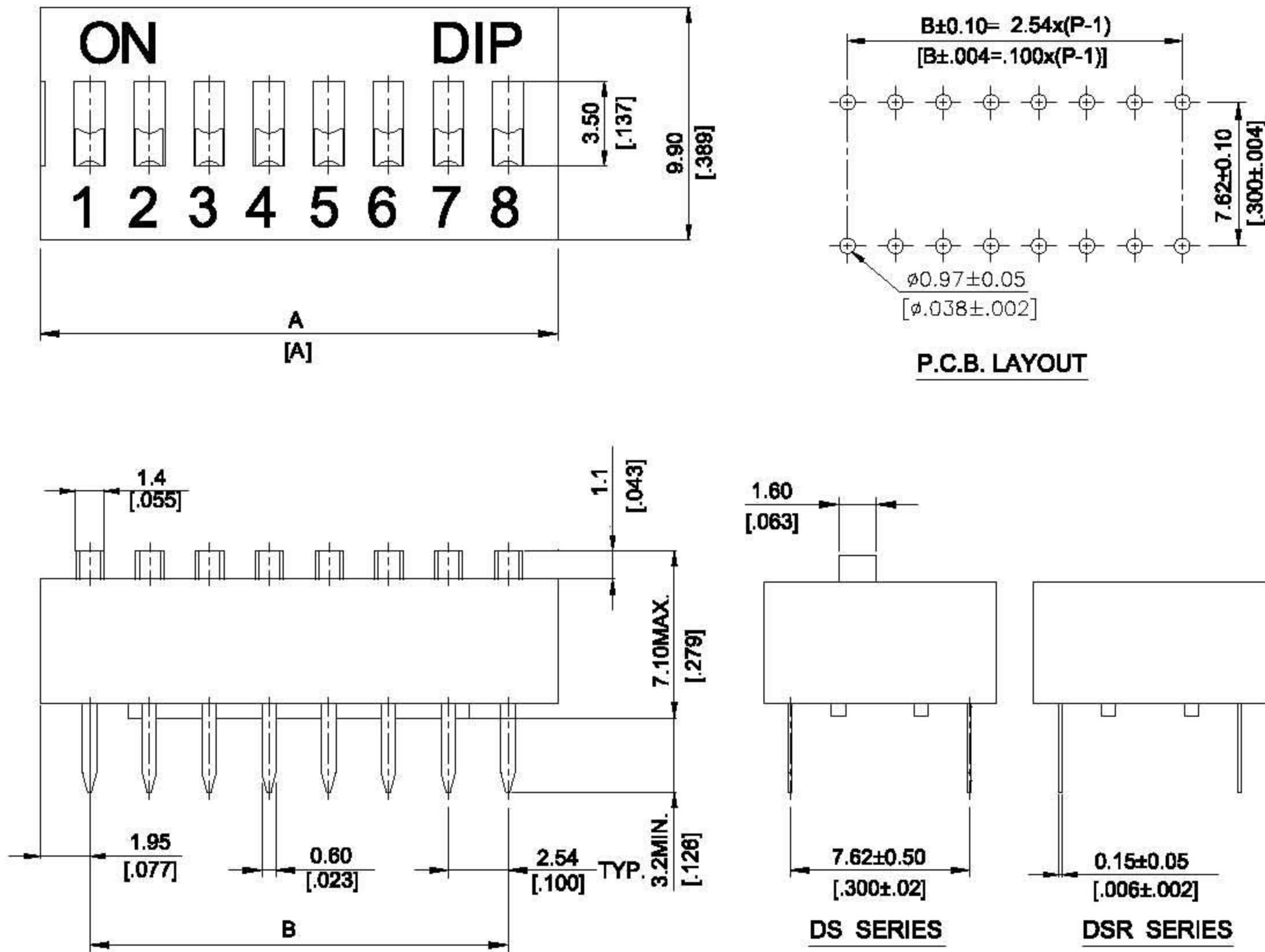

DIMENSIONS

DS(R)



DS -12-V	12	31.84[1.254]	27.94[1.100]
DSR-12-V			
DS -10-V	10	26.76[1.054]	22.86[900]
DSR-10-V			
DS -09-V	9	24.22[954]	20.32[800]
DSR-09-V			
DS -08-V	8	21.68[854]	17.78[700]
DSR-08-V			
DS -07-V	7	19.14[754]	15.24[600]
DSR-07-V			
DS -06-V	6	16.60[654]	12.70[500]
DSR-06-V			
DS -05-V	5	14.06[554]	10.16[400]
DSR-05-V			
DS -04-V	4	11.52[454]	7.62[300]
DSR-04-V			
DS -03-V	3	8.98[354]	5.08[200]
DSR-03-V			
DS -02-V	2	6.44[254]	2.54[100]
DSR-02-V			
DS -01-V	1	3.90[153]	-
DSR-01-V			
PROD. NO.	NO. OF POS.	DIM. A	DIM. B

SCHEMATIC(TYP.)

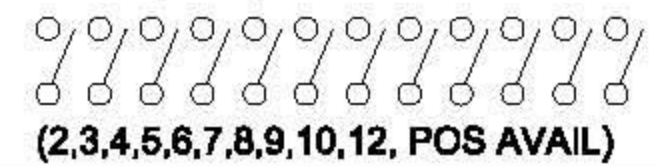

General Tolerance : ±0.2mm

DA

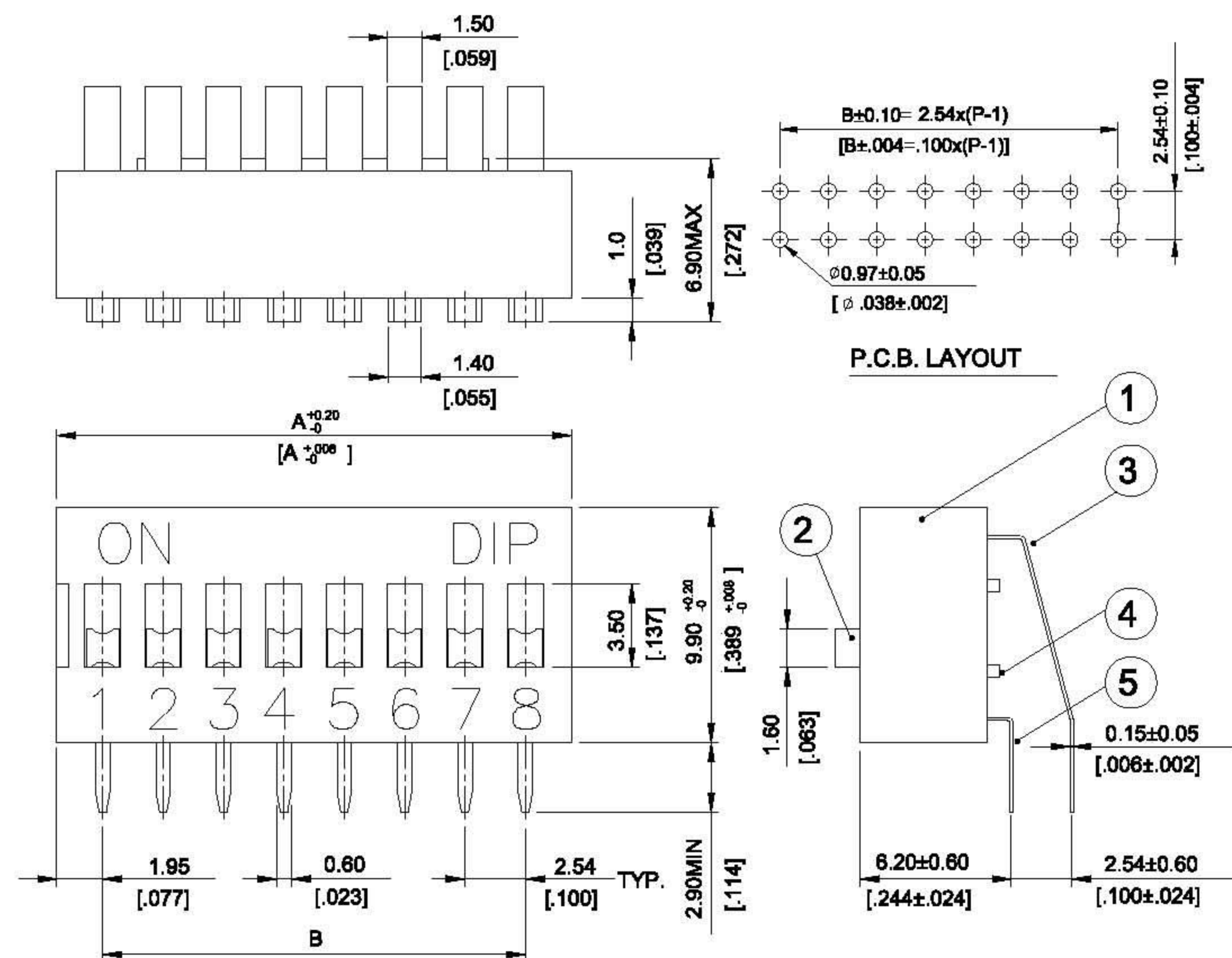

DA-12-V	12	31.84[1.254]	27.94[1.100]
DA-10-V	10	26.76[1.054]	22.86[900]
DA-09-V	9	24.22[954]	20.32[800]
DA-08-V	8	21.68[854]	17.78[700]
DA-07-V	7	19.14[754]	15.24[600]
DA-06-V	6	16.60[654]	12.70[500]
DA-05-V	5	14.06[554]	10.16[400]
DA-04-V	4	11.52[454]	7.62[300]
DA-03-V	3	8.98[354]	5.08[200]
DA-02-V	2	6.44[254]	2.54[100]
PROD. NO.	NO. OF POS.	DIM. A	DIM. B

SCHEMATIC(TYP.)

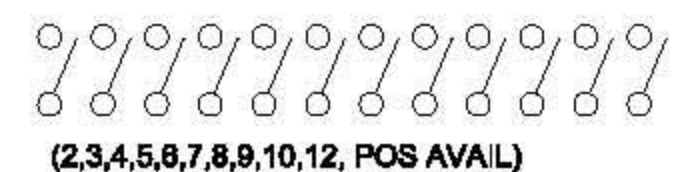

General Tolerance : ±0.2mm

DP(L)

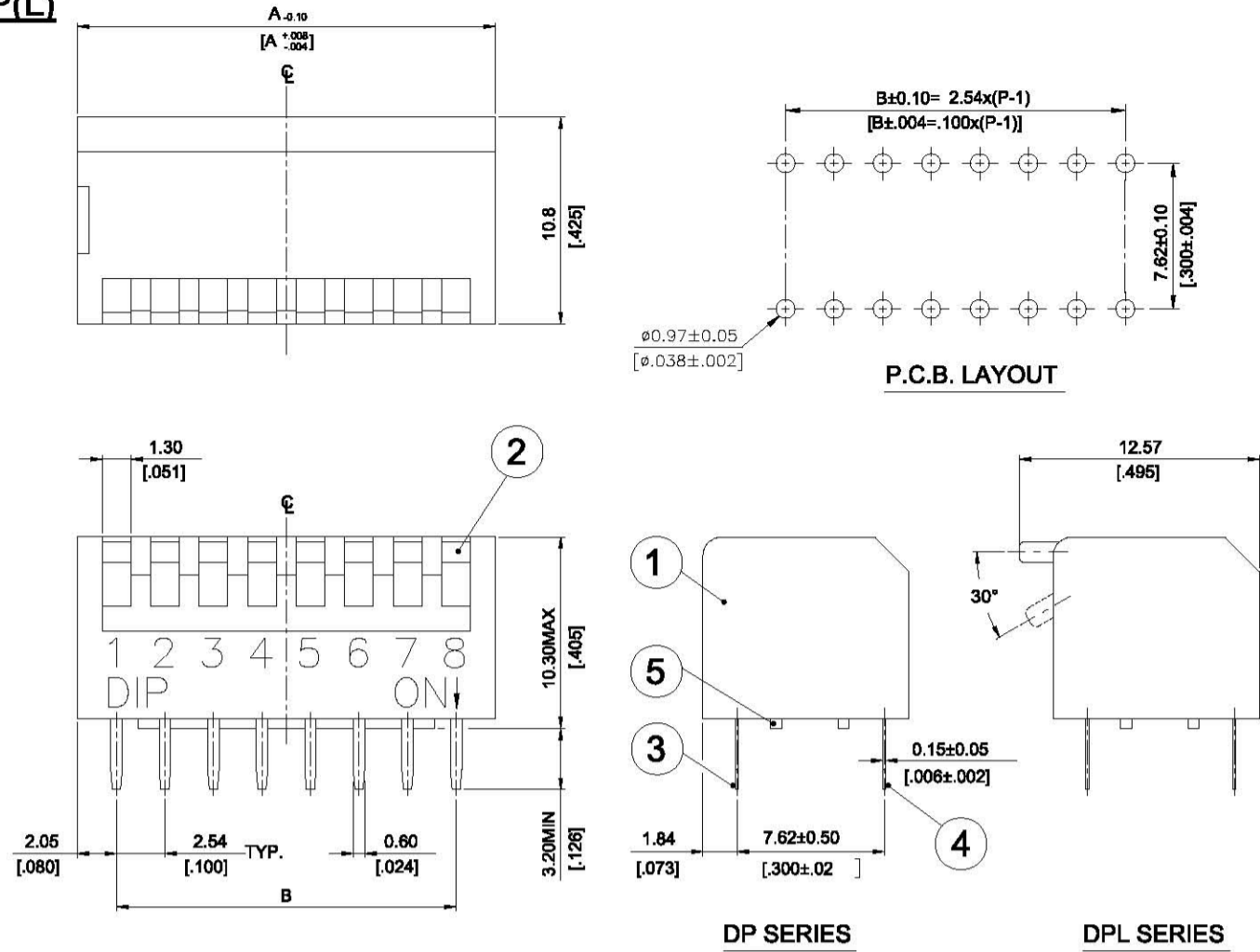

DP -12-V	12	32.04[1.261]	27.94[1.100]
DPL-12 -V			
DP -10-V	10	26.96[1.061]	22.86[.900]
DPL-10-V			
DP -09-V	9	24.42[.961]	20.32[.800]
DPL-09-V			
DP -08-V	8	21.88[.861]	17.78[.700]
DPL-08-V			
DP -07-V	7	19.34[.761]	15.24[.600]
DPL-07-V			
DP -06-V	6	16.80[.661]	12.70[.500]
DPL-06-V			
DP -05-V	5	14.26[.561]	10.16[.400]
DPL-05-V			
DP -04-V	4	11.72[.461]	7.62[.300]
DPL-04-V			
DP -03-V	3	9.18[.361]	5.08[.200]
DPL-03-V			
DP -02-V	2	6.64[.261]	2.54[.100]
DPL-02-V			

PROD. NO.	NO. OF POS.	DIM. A	DIM. B
SCHEMATIC(TYP.)			
(2,3,4,5,6,7,8,9,10,12, POS AVAIL)			

General Tolerance : $\pm 0.2\text{mm}$

HOW TO ORDER

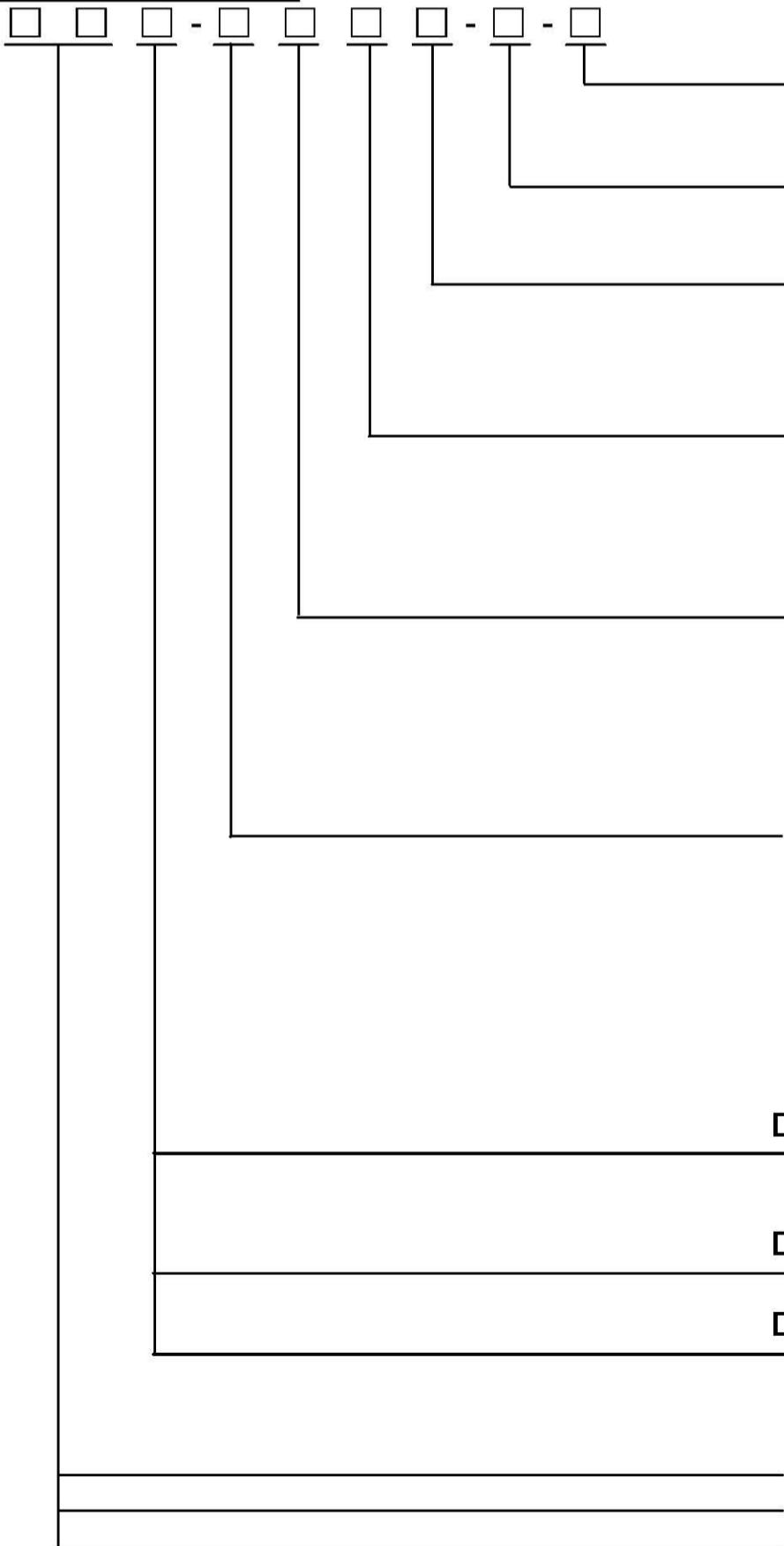

- Package :
 = Tube
- Soldering :
V = Lead Free Solderable
- Sealed :
 = Without Tape
T = Top Tape Sealed
- ▲ On/Off Position :
 = Push Down On
U = Push Down Off
<▲ U Only For DP(L)>
- Color Of Cover :
 = Red
▲ B = Blue
▲ K = Black
<▲ Subject to Our Final Confirmation>
- Number Of Position :
01 = 1 Positions <Only For DS(R)>
02 = 2 Positions 07 = 7 Positions
03 = 3 Positions 08 = 8 Positions
04 = 4 Positions 09 = 9 Positions
05 = 5 Positions 10 = 10 Positions
06 = 6 Positions 12 = 12 Positions
- DS
 = Raised Actuator
R = Recessed Actuator
- DA
 = Raised Actuator
- DP
 = Short Key
L = Long Key
- DS = Slide Type Dip Switch
DA = Right Angle Type Dip Switch
DP = Piano Type Dip Switch

SPECIFICATION

△MECHANICAL

Mechanical Life: 2,000 operations per switch.
Operation Force: 400gf max. (DP Series)
1,000gf max. (DS & DA Series)
Stroke: 2.0mm
Operation Temperature: -20°C to +70°C
Storage Temperature: -40°C to +85°C

△ELECTRICAL

Electrical Life: 2,000 operations per switch 24VDC,
25mA
Non-Switching Rating: 100mA , 50VDC
Switching Rating: 25mA , 24VDC
Contact Resistance: 50mΩ max. at initial
Insulation Resistance:{at 500 VDC} 100MΩ min.
Dielectric Strength: 500VAC / 1 minute
Circuit: SPST

MATERIAL

△BASE: UL94V-0 PBT Thermoplastic
Color: Black
△COVER UL94V-0 PBT Thermoplastic
Color: Red, Black, Blue
△ACTUATOR: UL94V-0 PBT High Thermoplastic
Color: White
△CONTACT: Phosphor bronze with gold plating over
nickel
△TOP SEAL: Polyester Film
△POTTING MATERIAL: Epoxy

SOLDERING PROCESS

- △Keep all switch contacts in their "OFF" position for all operations.
- △WAVE SOLDERING: Recommended temperature at 500°F (260°C) max. 5 seconds for through hole type.
- △HAND SOLDERING: Use a soldering iron of 30 watts, controlled at 350°C approximately max 5 seconds.
- △Make sure switch is in "OFF" position during soldering process, or it will decrease the operating force and meanwhile increase the contact resistance.
- △Do not wash the switch body except top tape sealed type, which suitable for spray cleaning method from top of the s/w.

PACKING

Part Number	Number Per Tube	Part Number	Number Per Tube
DS(R)-01	126	DS(R)-02-T	125
DS(R)-02	72	DS(R)-02-T	70
DS(R)-03	51	DS(R)-03-T	50
DS(R)-04	40	DS(R)-04-T	39
DS(R)-05	32	DS(R)-05-T	32
DS(R)-06	27	DS(R)-06-T	28
DS(R)-07	24	DS(R)-07-T	24
DS(R)-08	21	DS(R)-08-T	21
DS(R)-09	19	DS(R)-09-T	19
DS(R)-10	17	DS(R)-10-T	17
DS(R)-12	14	DS(R)-12-T	14
DP(L)-02	70	DP(L)-02/T	65
DP(L)-03	50	DP(L)-03-T	49
DP(L)-04	39	DP(L)-04-T	39
DP(L)-05	32	DP(L)-05-T	32
DP(L)-06	27	DP(L)-06-T	27
DP(L)-07	24	DP(L)-07-T	24
DP(L)-08	21	DP(L)-08-T	21
DP(L)-09	19	DP(L)-09-T	19
DP(L)-10	17	DP(L)-10-T	17
DP(L)-12	14	DP(L)-12-T	14
DA-02	73	DA-02-T	70
DA-03	52	DA-03-T	50
DA-04	40	DA-04-T	39
DA-05	33	DA-05-T	32
DA-06	28	DA-06-T	28
DA-07	24	DA-07-T	24
DA-08	21	DA-08-T	21
DA-09	19	DA-09-T	19
DA-10	17	DA-10-T	17
DA-12	14	DA-12-T	14

DS(R)

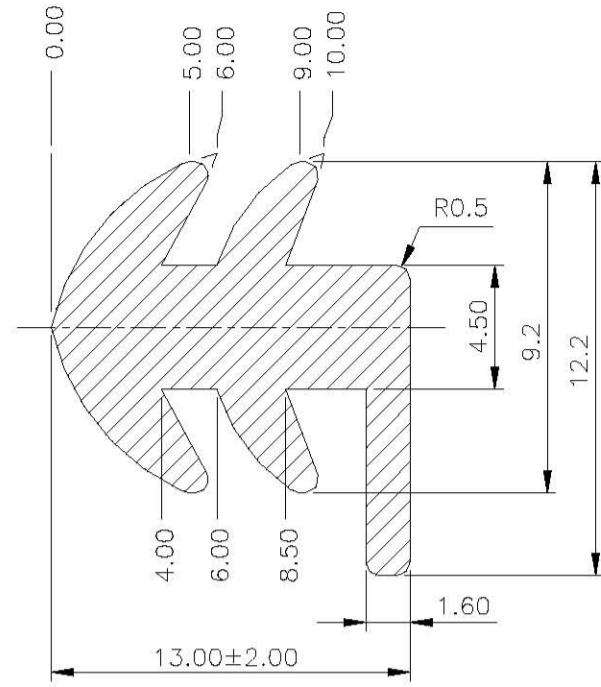
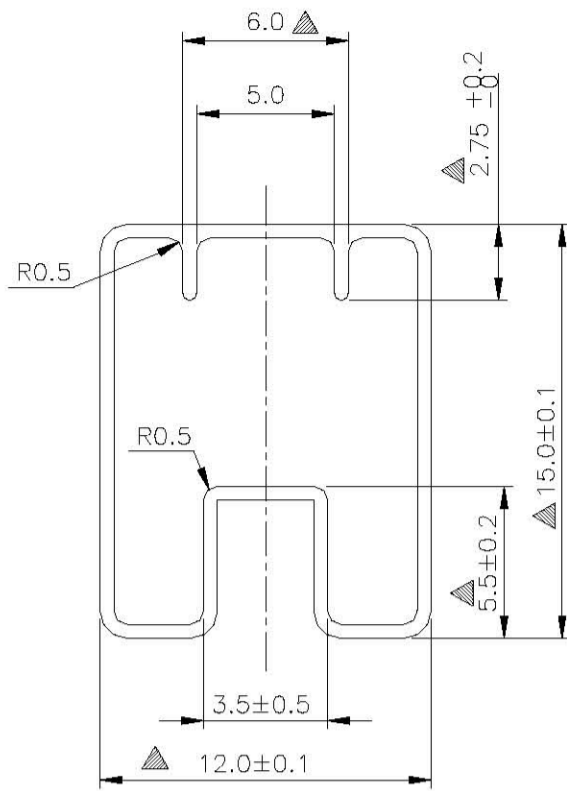

General Tolerance : ±0.2mm

DP(L)

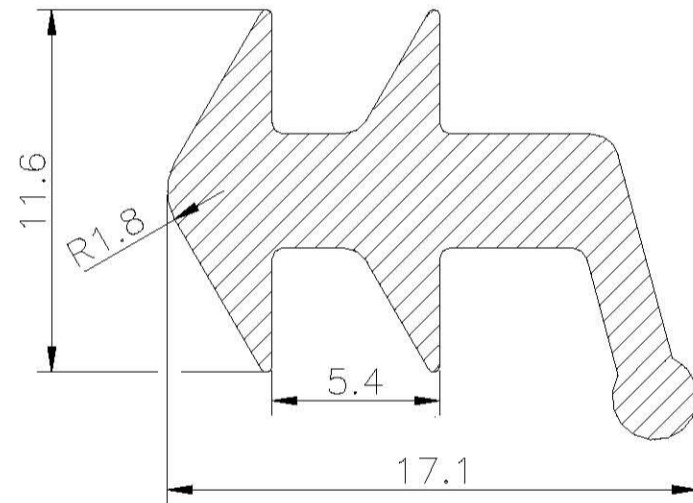
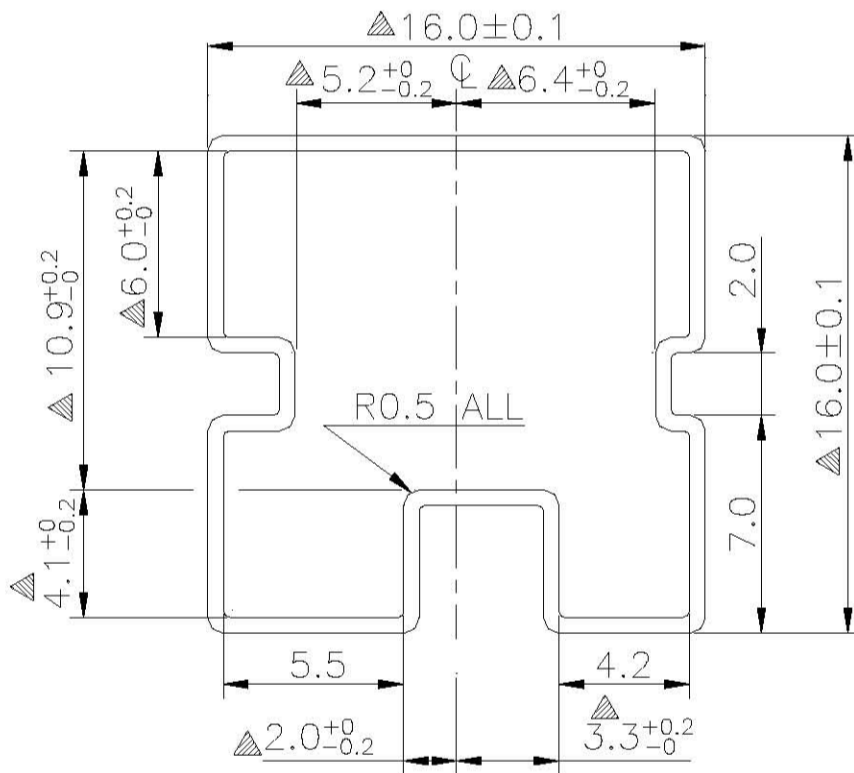

General Tolerance : ±0.2mm

DA

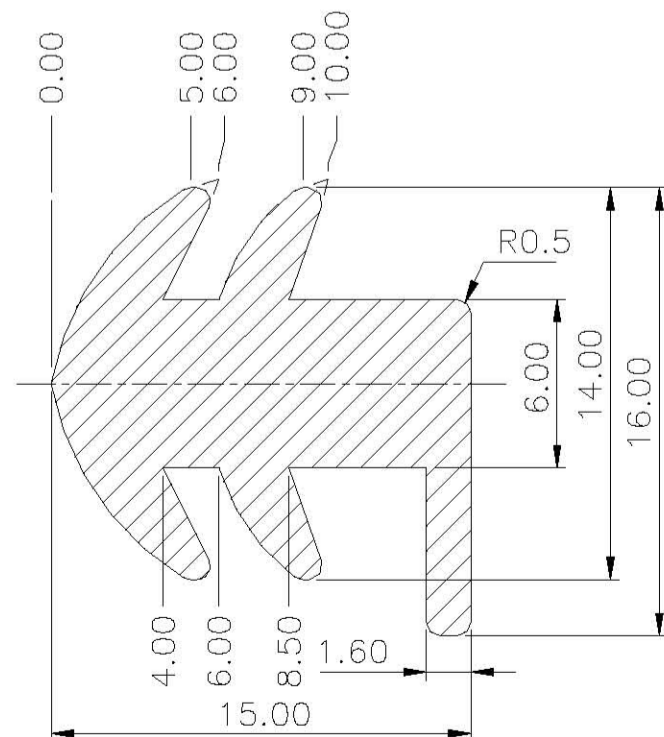
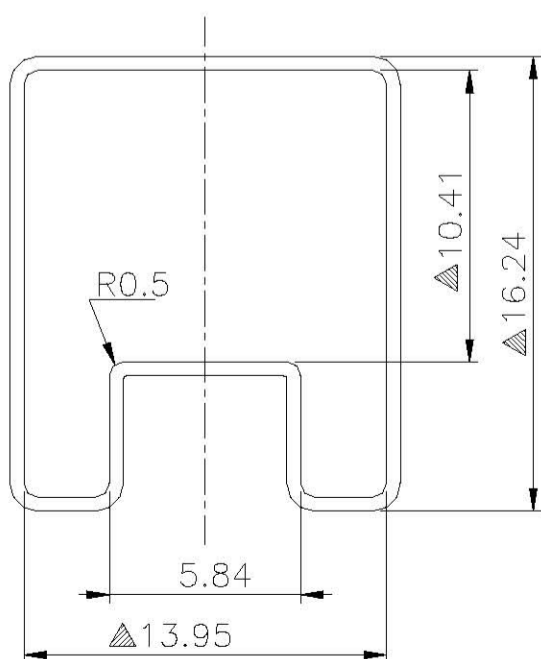

General Tolerance : ±0.2mm